

PRIVATE WATERFRONT LOTS

The Shores at Toney Bay

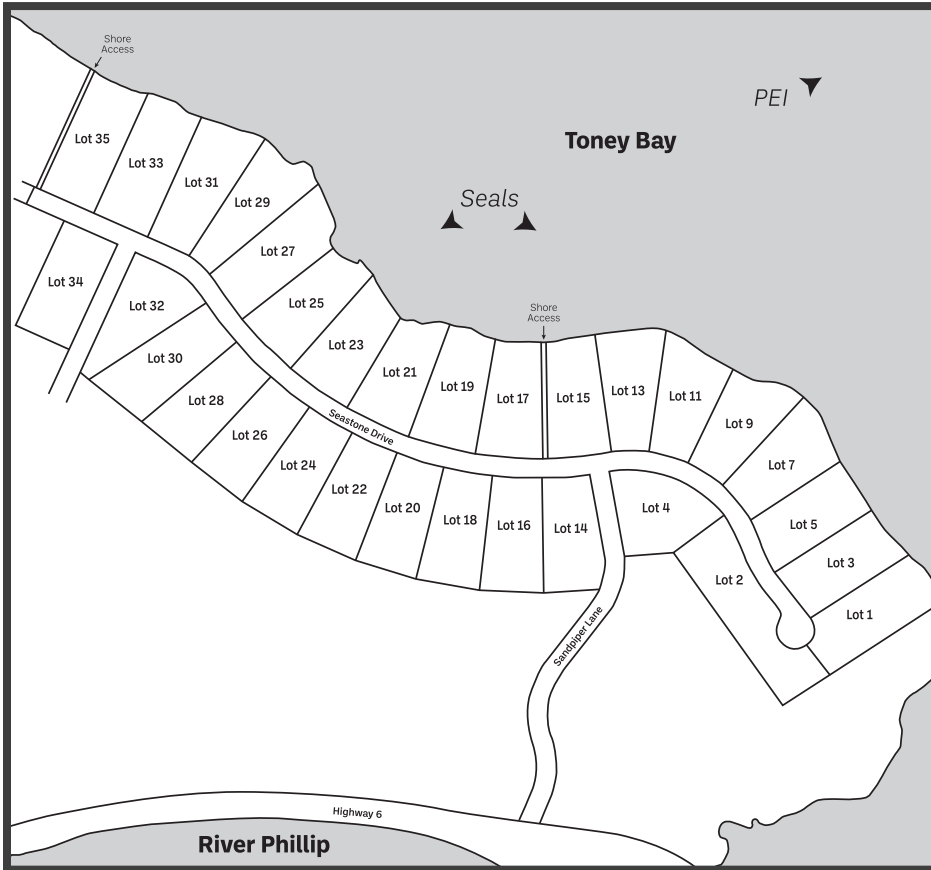

LOCATION

10 minutes from Pugwash,
30 minutes from Amherst,
30 minutes from Wentworth

LOT SIZE

1.5-2 Acres

WATERFRONT

175-225 Feet

PRICE

\$24,900-\$69,900

CALL STEVE FOR PRIVATE VIEWING

902-818-1601

Discover the open water of the Northumberland with the incredible views of Toney Bay! These flat, READY TO BUILD SITES offer direct waterfront with stunning pastoral views. Visit the local colony of seals, practice your photography in a bird lovers paradise or fish along the River Phillip – one of the best salmon fishing rivers in the province. Shop at the lobster pound or jump in your boat at the marina – both are right across the street. Your large oceanfront lot will have scenes of green idyllic fields against the blue ocean and sky. With year-round access, you can be skiing at Wentworth in a half-hour or golfing at a variety of courses only minutes from home. The Shores of Toney Bay are where you can celebrate all the traditions of a true Nova Scotia lifestyle and enjoy the warmest waters north of the Carolinas right here, right now. *A select group of water view lots also available.*

STEPHEN O'LEARY | 902.818.1601 (Direct) | stephen@watersedgeLL.com |   

Visit our website for more photos and drone video

www.livewatersedge.ca