

# PRIVATE WATERFRONT LOTS

## Brooklyn Shore

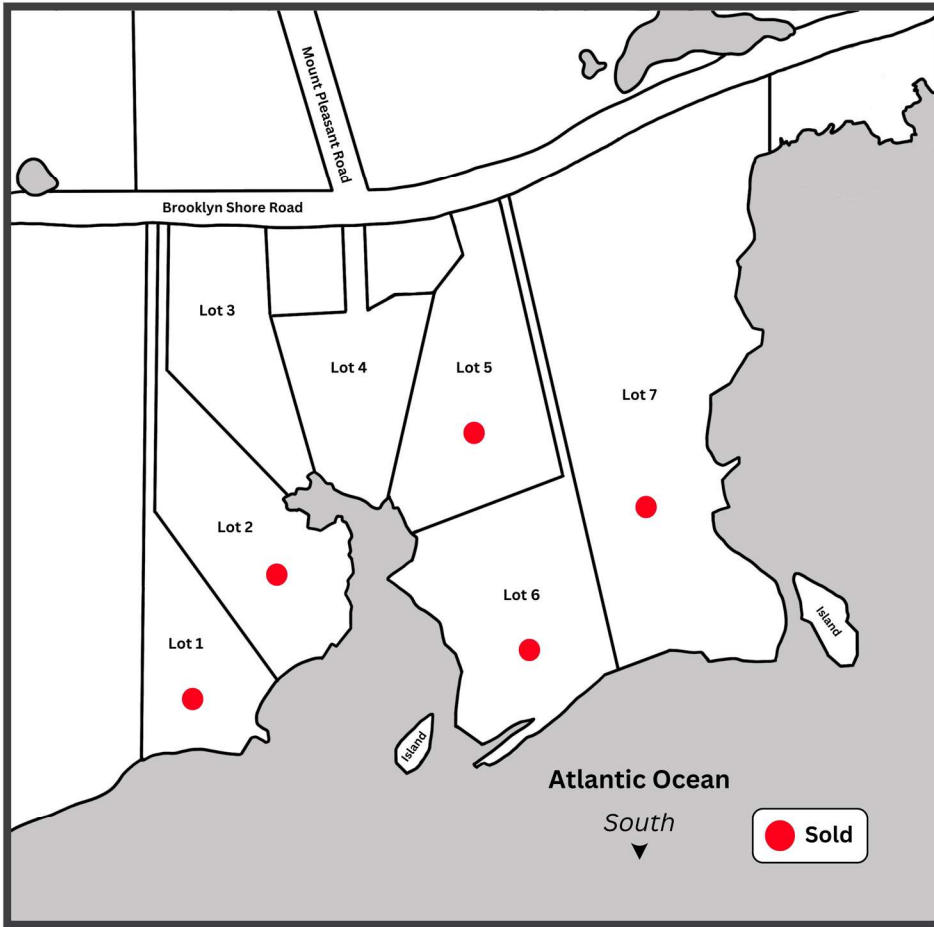

### LOCATION

30 minutes from Bridgewater,  
5 minutes to Liverpool

### LOT SIZE

2.5-6 acres

### WATERFRONT

Up to 1550 Feet

### ORIENTATION

South Facing

### PRICE

\$125,000 - \$175,000

### CALL STEVE FOR PRIVATE VIEWING

902-818-1601

Own one of the views that makes Nova Scotia famous with this rare offering of oceanfront lots. Choose your own private sand beach or a personal cove. Each morning, your water view will be different – will the waves wake you up as they crash into the granite rocks, or will the water be quiet and serene? Imagine watching the full moon cast light on the ocean as you raise a toast with your friends to another spectacular day at the shore while overlooking the everchanging ocean from your deck. These extra-large lots are perfect for your exclusive get away. Forget your urban lifestyle, relax with the smell of salt air and watch the deer in your yard. Your biggest challenge here will be choosing lobster or halibut – who says life at the beach is easy? These are hard choices you will face. I hope you are prepared!

**STEPHEN O'LEARY** | 902.818.1601 (Direct) | [stephen@watersedgeLL.com](mailto:stephen@watersedgeLL.com) |   

Visit our website for more photos and drone video  
[www.livewatersedge.ca](http://www.livewatersedge.ca)